

# ***kdS* Stainless Steel Syringes**



## **Premium Line of Stainless Steel Syringes**

A premier line of stainless steel syringes is now offered by KD Scientific. These syringes are a perfect complement for the NEW KDS 410 high force pump. Rugged stainless steel syringes are an ideal solution when the pressures and the force are high, completely eliminating the problem of breaking glass syringes.

Stainless steel offers good resistance to most aggressive liquids. Wetted parts are #316 stainless steel and Viton or Perfluoroelastomer. Syringes are available in 2.5, 8, 20, 50, 100 and 200 ml sizes with removable replaceable tips. Genuine SWAGELOK™ syringe to tube fittings are available in 1/16, 1/8 and 1/4 inch sizes. A luer lock end fitting is also available. Tips are interchangeable with all syringes from 20 to 200 ml in size.

Both syringe barrel and plungers are #316 stainless steel. An O-ring seal between the top and end of the barrel protects against leakage. Syringes are guaranteed to be leak free for pressures up to 7000 psi (see detailed specifications).

All syringes are supplied with inside diameter dimensions for use with the KDS 410 series. Replacement Viton O-rings are available as are more chemically resistant Perfluoroelastomer O-rings.

KD Scientific also offers a family of syringe pumps to meet all different applications. The full line of KDS pumps includes a simple single syringe dispense only pump, a multi-syringe infuse and withdrawal pump, push and pull pumps, continuous pumps for uninterrupted fluid delivery, nanoliter pumps, and an emulsifier pump. KD Scientific is world renown for its unsurpassed quality and reliability.

SWAGELOK™ is a registered trademark.

**NOTE:** KD Scientific syringes are for laboratory use only. They have not been approved by the FDA for clinical use.

# ***kdS* Scientific**

# **NEW! Premium Line of Stainless Steel Syringes**

## **Benefits**

- Compatible with most syringe pumps
- Rugged construction #316 stainless steel
- Eliminate hazards of glass syringe breakage
- Reuseable - fully autoclavable
- Adaptable to Luer Lock or SWAGELOK™ fittings
- Resistance to most chemicals
- Durable construction - Electron beam welded

## **Features**

- Full range of sizes 2.5 ml to 200 ml
- 1/16" SWAGELOK™ fitting for low dead volume
- Leak free to pressures up to 7000 psi
- Multi-style tips are interchangeable
- Replacement O-Rings available

## **Applications**

- High pressure applications
- Dispensing fluids
- Withdrawing fluids

## **Markets**

- Pharmaceutical
- Biotech
- Chemical
- Petrochemical
- Neuroscience
- Research and Development
- Government
- Food and Beverage

### **Agence Nord:**

ZA Object'ifs Sud - Lot A3  
6 Allée Emilie du Châtelet  
14123 Ifs  
tél : 02.31.34.50.74  
fax : 02.31.34.55.17

### **Agence Sud:**

Bât Le Venango. 392 Rue Jean Dausset  
AGROPARC - BP11575  
84916 Avignon Cédex 9  
tél : 04.90.27.17.95 fax : 04.90.27.17.52



### **Agence Est:**

Parc Club des Tanneries  
2 Rue de la Faisanderie  
67380 Lingolsheim  
tél : 03.88.04.01.81  
fax : 03.68.93.01.52

[www.deltalabo.fr](http://www.deltalabo.fr)  
[info@deltalabo.fr](mailto:info@deltalabo.fr)

## Specifications

Volume	2.5 ml	8 ml	20 ml	50 ml	100 ml	200 ml
Dimensions:	in (mm)	in (mm)	in (mm)	in (mm)	in (mm)	in (mm)
Overall Length of Barrel - (L1)	6.64 (168.7)	6.73 (170.8)	4.73 (120.0)	5.49 (139.3)	6.73 (170.9)	8.48 (215.3)
Stroke - (S)	5.41 (137.4)	4.42 (112.4)	2.74 (69.6)	3.06 (77.83)	4.12 (104.5)	5.06 (128.45)
Outside Diameter - (OD)	0.50 (12.7)	0.50 (12.7)	0.88 (22.2)	1.25 (31.8)	1.50 (38.1)	1.88 (47.63)
Inside Diameter - (ID)	0.191 (4.85)	0.375 (9.525)	0.753 (19.13)	1.126 (28.60)	1.374 (34.90)	1.762 (44.75)
Maximum Test Pressure	9000 psi	4000 psi	1500 psi	1500 psi	1500 psi	1500 psi
Working Pressure	7000 psi	1500 psi	700 psi	700 psi	700 psi	700 psi
Order Code Syringe with SWAGELOK™ 1/16"	780801	780802	780803	780804	780805	780806
Order Code Syringe with SWAGELOK™ 1/8"	N/A	780807	780808	780809	780810	780811
Order Code Syringe with SWAGELOK™ 1/4"	N/A	N/A	780812	780813	780814	780815
Order Code Syringe with Luer Lock	N/A	N/A	780816	780817	780818	780819
O-Ring Material	Perfluoroelastomer	Perfluoroelastomer	Viton	Viton	Viton	Viton

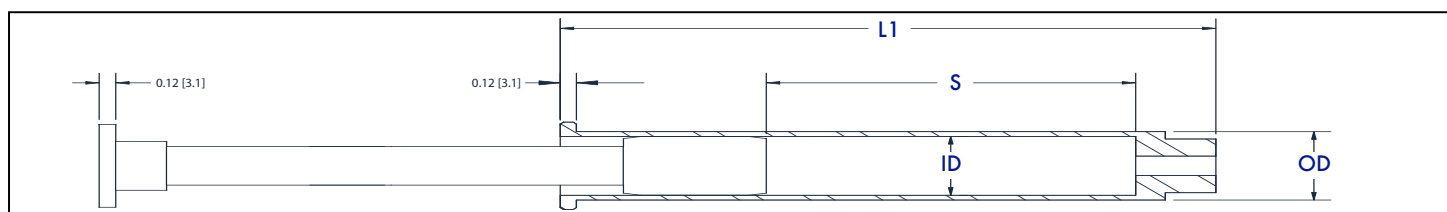

## Replacement Parts

- 780830 Replacement Seal 2.5 ml, qty. 1
- 780831 Perfluoroelastomer O-Ring 8 ml, qty. 2
- 780832 TEFLON Backup-Ring Teflon 8 ml, qty. 2
- 780833 Perfluoroelastomer Tip Seal O-Ring 2.5 or 8 ml, qty. 1
- 780834 Perfluoroelastomer O-Ring 20 ml, qty. 2
- 780835 Perfluoroelastomer O-Ring 50 ml, qty. 2
- 780836 Perfluoroelastomer O-Ring 100 ml, qty. 2
- 780837 Perfluoroelastomer O-Ring 200 ml, qty. 2
- 780838 Replacement Viton O-Ring 20 ml, pkg. of 10
- 780839 Replacement Viton O-Ring 50 ml, pkg. of 10
- 780840 Replacement Viton O-Ring 100 ml, pkg. of 10
- 780841 Replacement Viton O-Ring 200 ml, pkg. of 10
- 780842 Perfluoroelastomer Tip Seal O-Ring 20 to 200 ml, qty. 1
- 780843 Replacement Viton Tip Seal O-Ring Seal 20 to 200 ml, pkg. of 20
- 780844 1/16" SWAGELOK™ Fitting for 2.5 to 8 ml Syringes, qty. 1
- 780845 1/8" SWAGELOK™ Fitting for 2.5 to 8 ml Syringes, qty. 1
- 780846 1/16" SWAGELOK™ Fitting for 20 to 200 ml Syringes, qty. 1
- 780847 1/8" SWAGELOK™ Fitting for 20 to 200 ml Syringes, qty. 1
- 780848 1/4" SWAGELOK™ Fitting for 20 to 200 ml Syringes, qty. 1
- 780849 Luer Lock Fitting for 20 to 200 ml Syringes, qty. 1

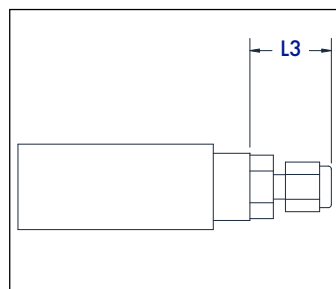

Syringe	Fitting	L3 in (mm)
2.5 to 8 ml	1/16	0.74 (18.8)
2.5 to 8 ml	1/8	0.91 (23.1)
20 to 200 ml	1/16	0.67 (17.0)
20 to 200 ml	1/8	0.84 (21.3)
20 to 200 ml	1/4	0.94 (23.9)
20 to 200 ml	Luer	1.34 (34.0)

